

# Traffic Calming Program Information Session - Strategy Presentation

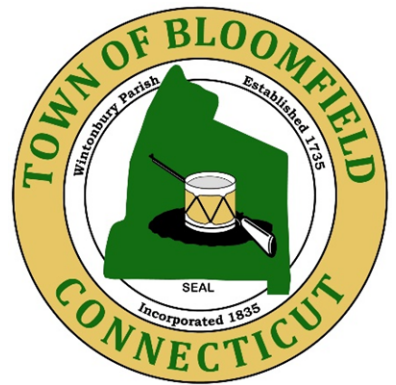

## Maple Avenue & Woodland Avenue



November 30, 2022

## **Traffic Calming Strategy Presentation – Next Steps**

Bloomfield Traffic Calming Program next steps following neighborhood information session for strategy presentation:

### **Neighborhood Support**

- A survey will be conducted of adjacent property owners and area property owners to gauge support for the proposed traffic calming measures.
- A mailing will be sent out with hard copy of the survey, basic information on the proposed measures, and link information web information discussed below.
- The survey will also be available on-line, along with more detailed information about proposed measures.
- Each property will be allowed one [and only one] response to the survey.
- In order for the proposed traffic calming measures to proceed under the program:
  - ✓ Greater than 50% of the benefitting properties (directly adjacent) must respond in support of the measure.
  - ✓ Not greater than 50% of the interested properties (total affected area) may respond in non-support of the measure.

### **Town Council Steps**

- The Town Council finalizes the priority scoring for the strategy/project. In the finalization process, the Council may determine to award the project bonus scoring (up to 5 points), as provided on the Traffic Calming Program Priority Scoring Sheet, to account for environmental factors, neighborhood factors, timing, public health benefits, etc. The Priority Scoring Sheet can be found in the Traffic Calming Manual.
- The Council approves the project to be added to the Traffic Calming Priority Project List based upon its final priority score. The Traffic Calming Priority Project List is a list of approved projects that is populated by the Town Council and is administered by the LRSC.

### **Funding**

- Possible funding sources are traffic calming capital (CIP) funding, other CIP funding, grants, etc.
- The current balance of the traffic calming capital account is approximately \$44,000.
- At most times moving forward, the cost of improvements identified on the Council's Traffic Calming Priority Project List will exceed the available funding.
- The timing and selection of funding improvements will be based on:
  - » The priority scoring on the Traffic Calming Priority Project List
  - » Currently available funding
  - » Directives from the Town Council
  - » Cost/benefit/timing considerations
  - » Potential future grants or other funding opportunities
  - » Professional judgement of the LRSC



# Traffic Calming Program Proposed Measures

## Offset Choker - Example



## Bloomfield Offset Choker Detail

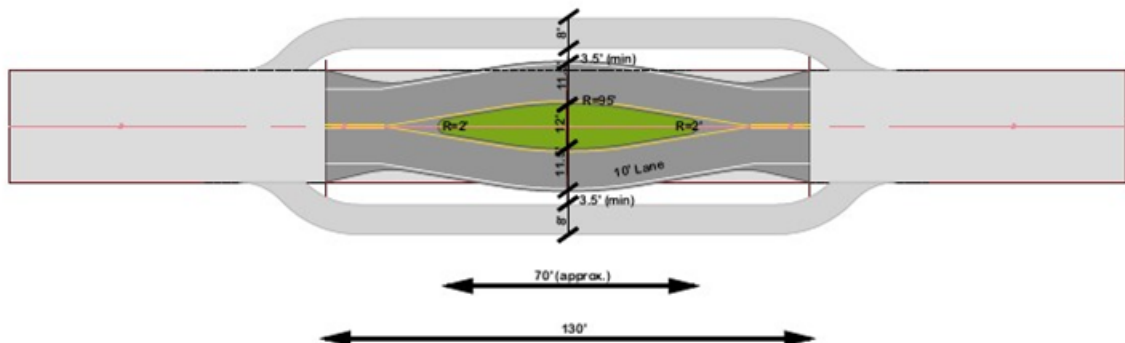



# Traffic Calming Program Proposed Measures

**Raised Intersection - Example**



**Raised Intersection - Example**

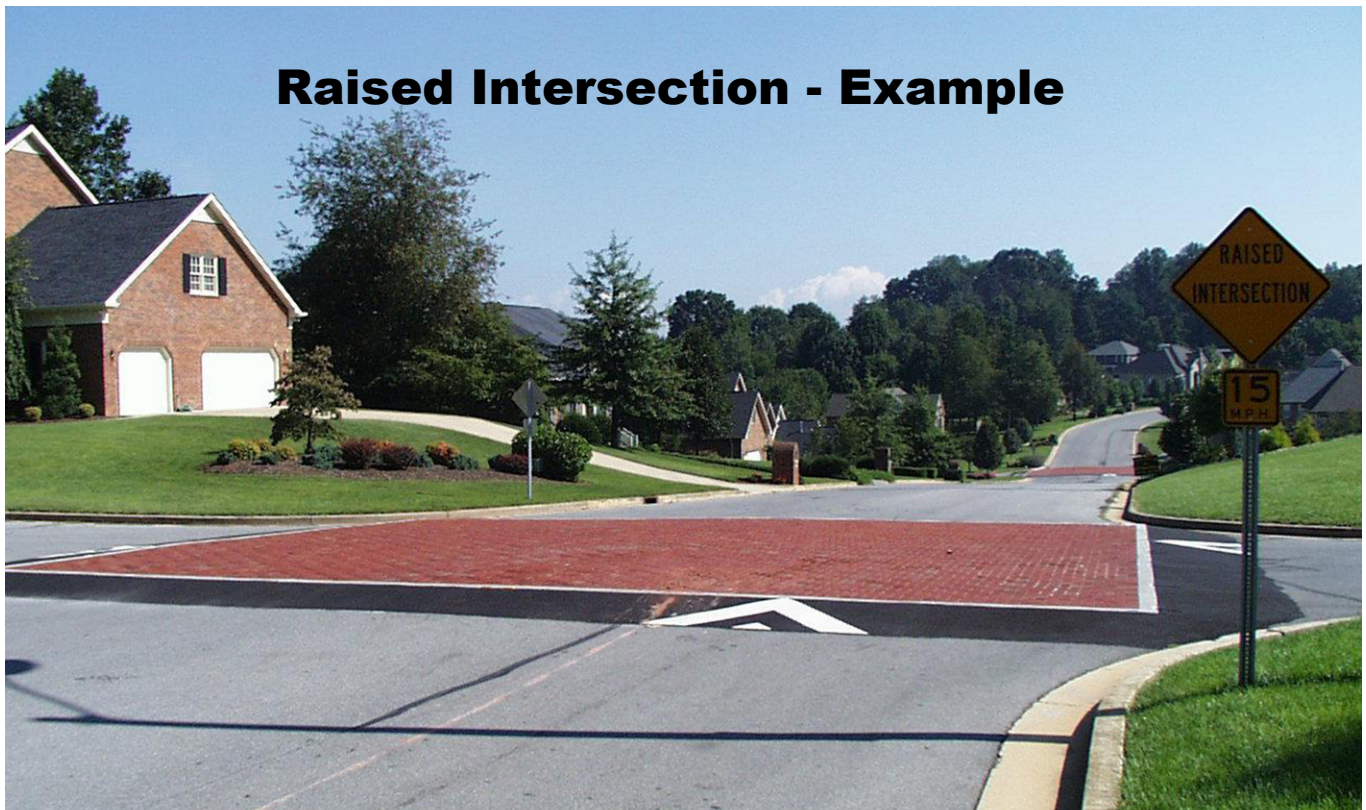



# Traffic Calming Program

## Proposed Measures

**Mini Roundabout - Example**



**Mini Roundabout - Example**



## **Proposed Traffic Calming on Maple Avenue**

The Local Road Safety Committee (LRSC) is seeking authorization to implement traffic calming measures on Maple Avenue.

### **Background**

After the submission of a traffic calming request form, the following data was collected for Prospect Street:

- Classified as an urban collector road with a posted speed limit of 35 mph
- Street length [of affected roadway] is ≈ 4,500 feet
- 85<sup>th</sup> Percentile Speed of 44.0 mph; average speed of 37.2 mph
- Average Daily Traffic (ADT) of 5500 - 6000 vehicles
- 5 crashes in the last 3 calendar years, 20 in the last 10 years

An initial Neighborhood Information Session was held on January 26, 2022 where residents identified excessive speeds, no sidewalks, running stop signs, and truck traffic as primary concerns.

### **Proposed Solution**

The LRSC has developed the following strategy to address the neighborhood concerns:

- Install 4 offset chokers and one raised intersection
- Install sidewalk on west side from Mountain Avenue south to Maple Avenue Extension
- Install sidewalk on east side from Mountain Avenue south to church



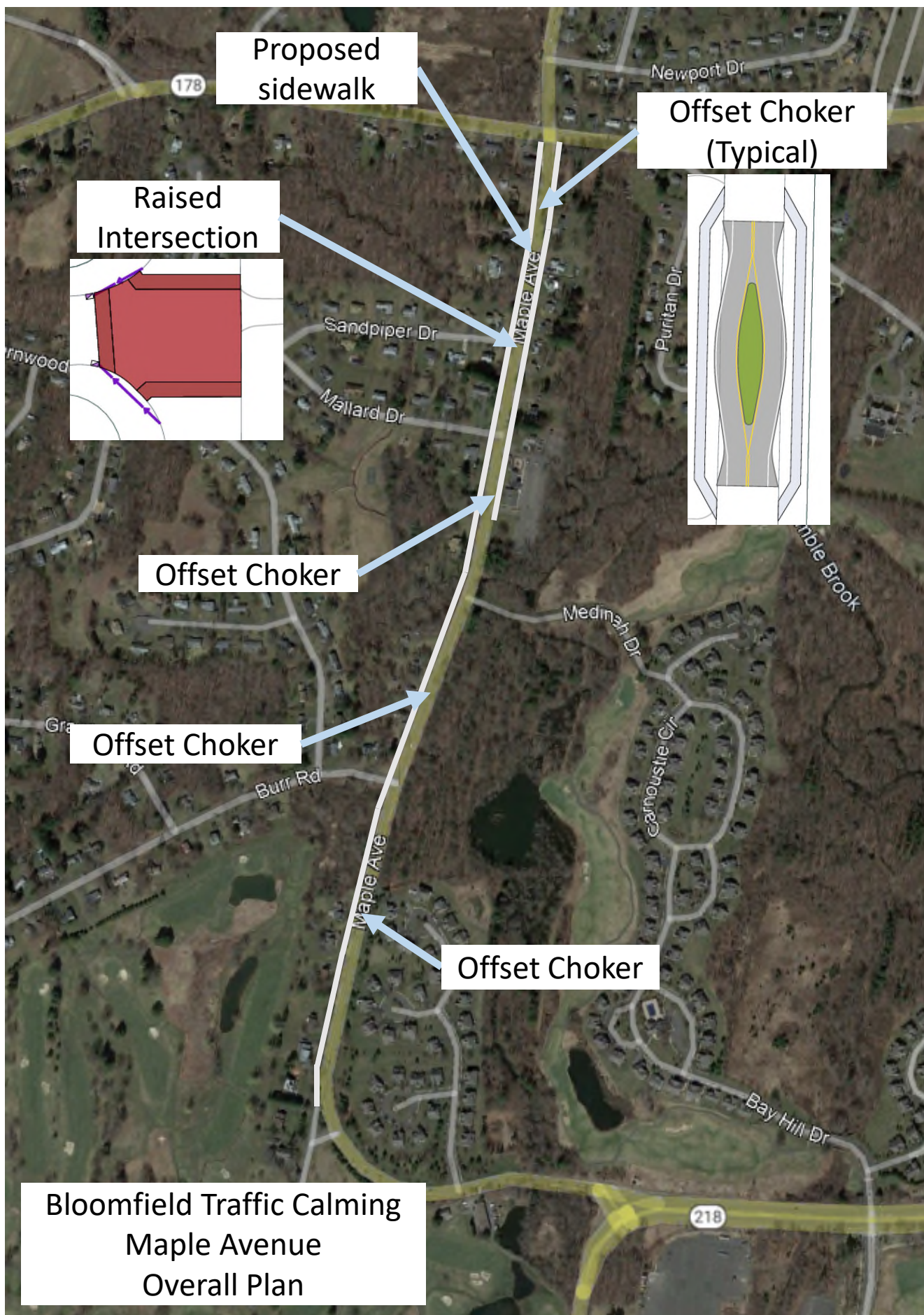

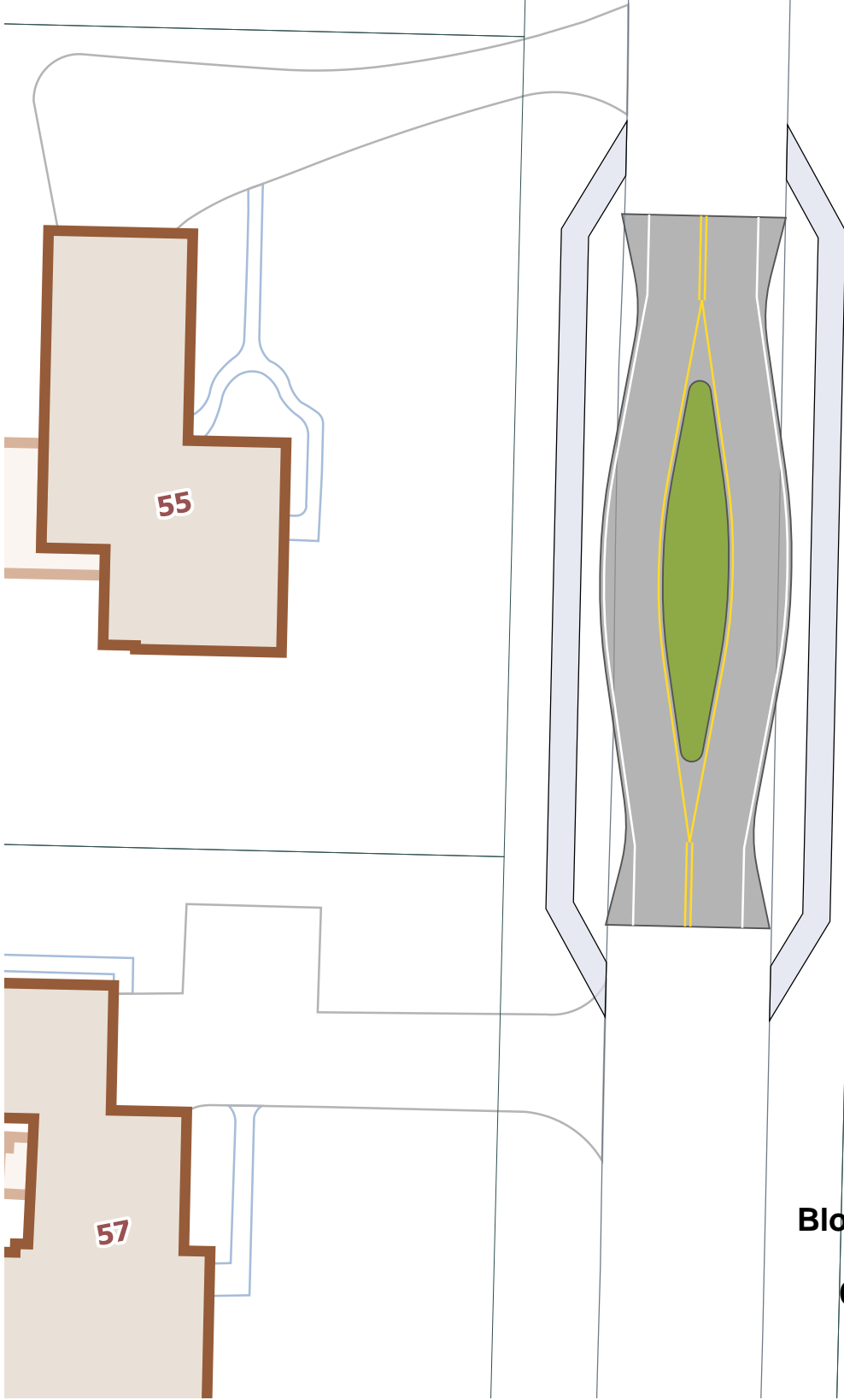

**Bloomfield Traffic Calming  
Maple Avenue  
650' South of Burr Road  
Offset Choker  
M-1**



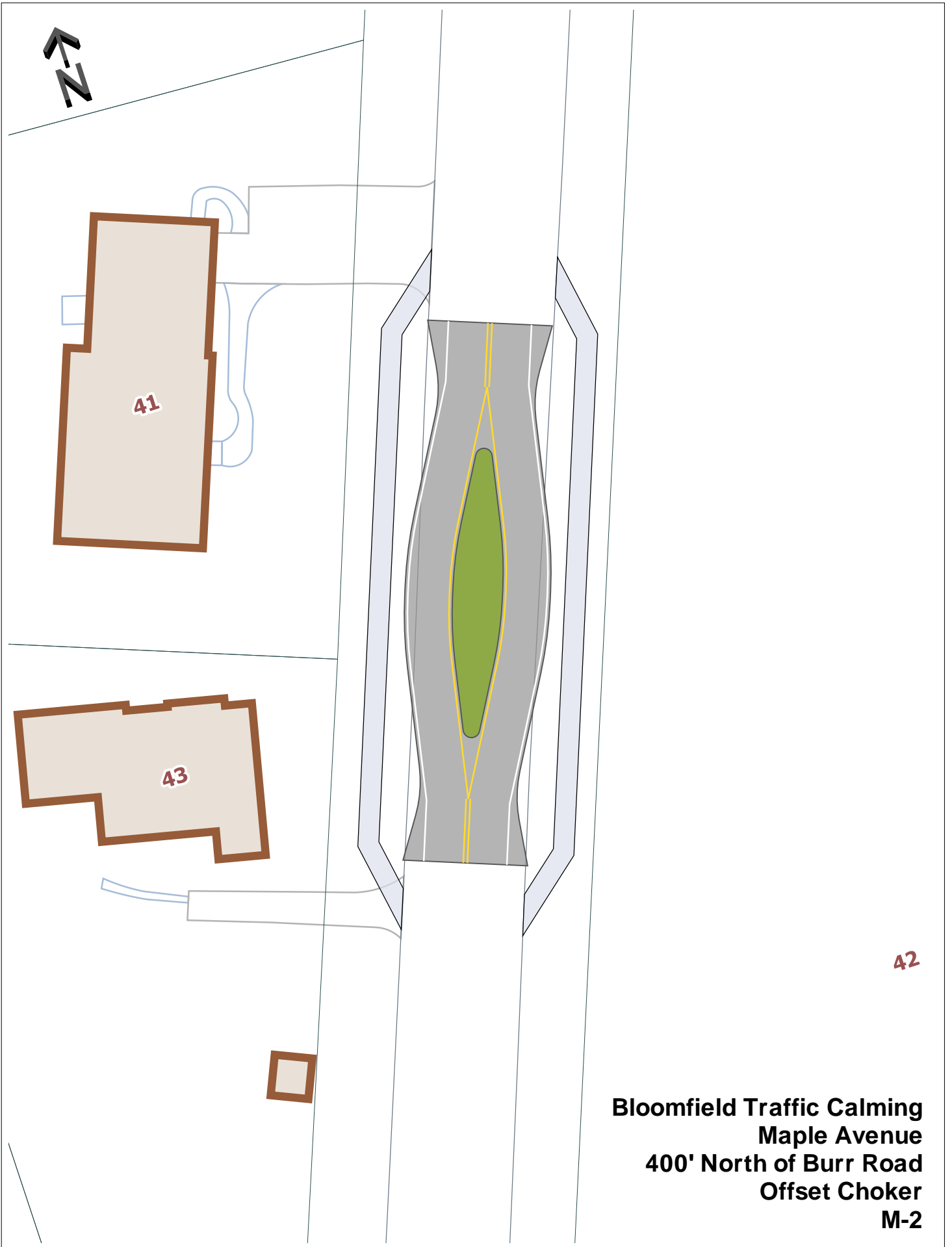

**Bloomfield Traffic Calming  
Maple Avenue  
400' North of Burr Road  
Offset Choker  
M-2**

**Bloomfield Traffic Calming  
Maple Avenue  
300' South of Mallard Drive  
Offset Choker  
M-3**

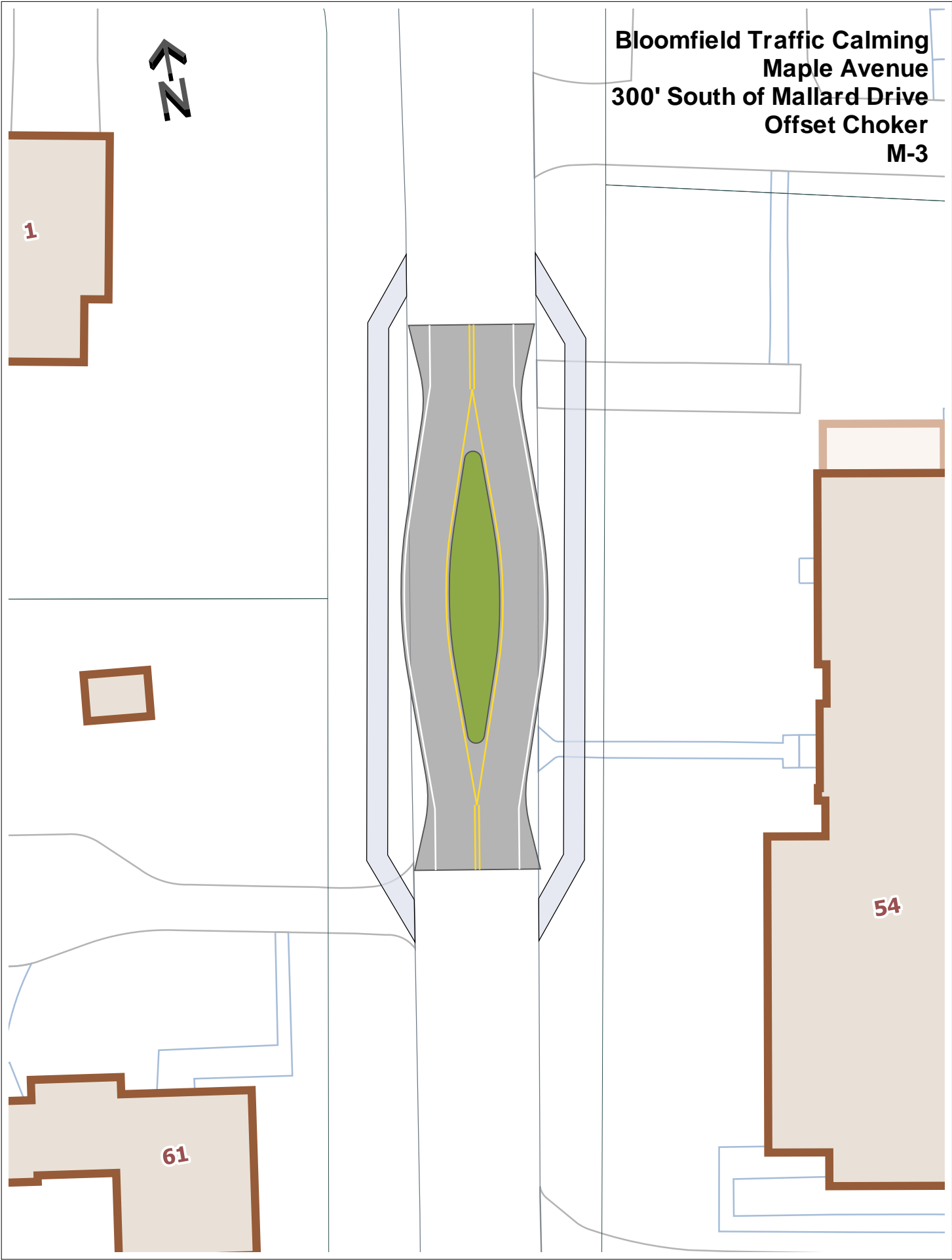



**Bloomfield Traffic Calming  
Maple Avenue  
At Sandpiper Drive  
Raised Intersection  
M-4**

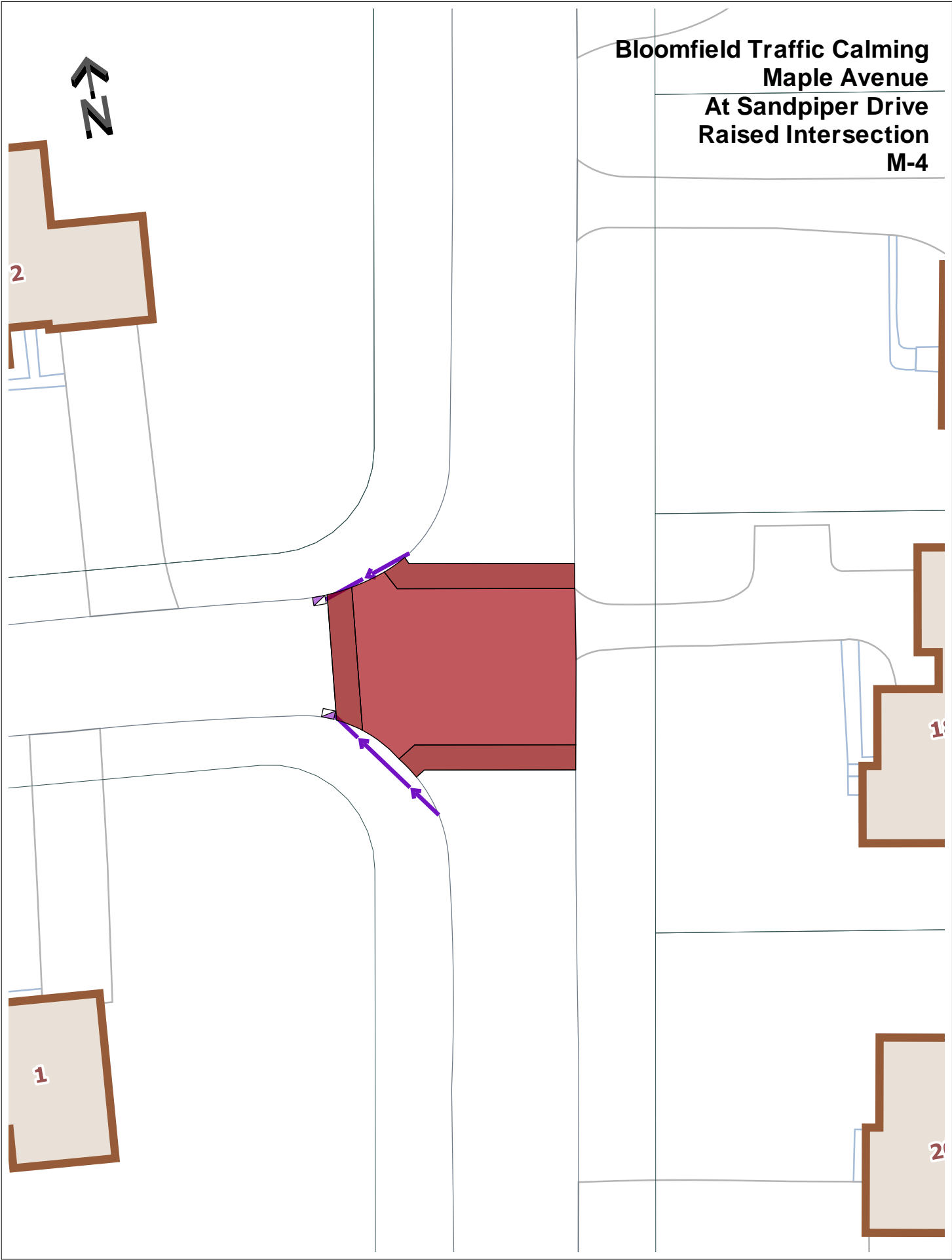

**Bloomfield Traffic Calming  
Maple Avenue  
400' South of Mountain Avenue  
Offset Choker  
M-5**

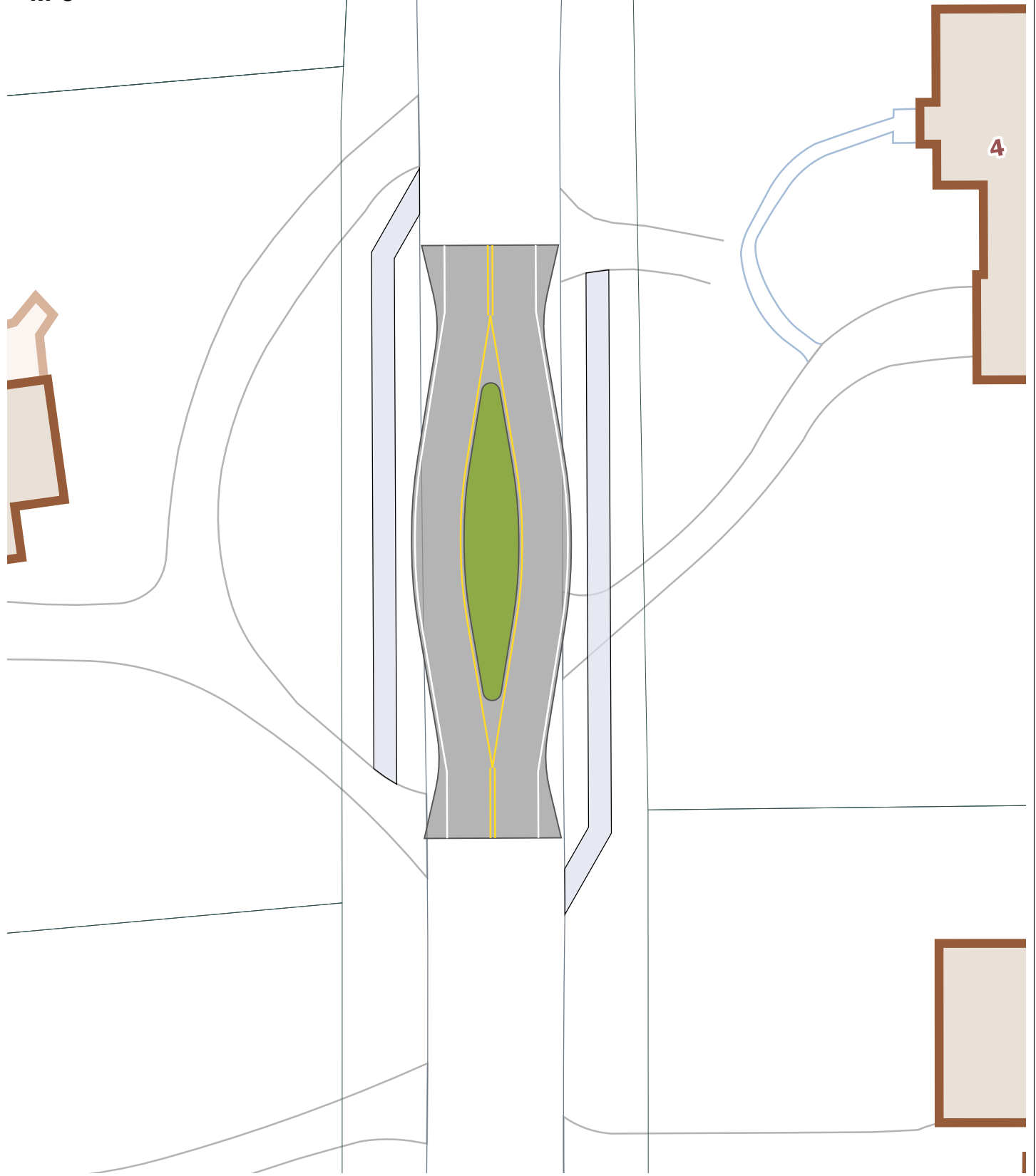



## **Proposed Traffic Calming on Maple Avenue**

The Local Road Safety Committee (LRSC) is seeking authorization to implement traffic calming measures on Maple Avenue.

### **Background**

After the submission of a traffic calming request form, the following data was collected for Prospect Street:

- Classified as an urban collector road with a posted speed limit of 35 mph
- Street length [of affected roadway] is ≈ 4,500 feet
- 85<sup>th</sup> Percentile Speed of 44.0 mph; average speed of 37.2 mph
- Average Daily Traffic (ADT) of 5500 - 6000 vehicles
- 5 crashes in the last 3 calendar years, 20 in the last 10 years

An initial Neighborhood Information Session was held on January 26, 2022 where residents identified excessive speeds, no sidewalks, running stop signs, and truck traffic as primary concerns.

### **Proposed Solution**

The LRSC has developed the following strategy to address the neighborhood concerns:

- Install 4 offset chokers and one raised intersection (\$375,000)
- Install sidewalk on west side from Mountain Avenue south to Maple Avenue Extension (\$740,000)
- Install sidewalk on east side from Mountain Avenue south to church (\$290,000)

## **Proposed Traffic Calming on Woodland Avenue**

The Local Road Safety Committee (LRSC) is seeking authorization to implement traffic calming measures on Maple Avenue.

### **Background**

After the submission of a traffic calming request form, the following data was collected for Prospect Street:

- Classified as an urban collector road with a posted speed limit of 30 & 35 mph
- Street length [of affected roadway] is ~ 9,250 feet (Wintonbury Ave to Peters Rd)
- 85<sup>th</sup> Percentile Speed of 39.1 mph; average speed of 31.0 mph (in 30 mph zone)
- Average Daily Traffic (ADT) of 6,600 vehicles
- 14 crashes in the last 3 calendar years, 48 in the last 10 years

An initial Neighborhood Information Session was held on April 28, 2021 where residents identified excessive speeds, illegal passing, truck traffic, and ATV/dirt bike traffic as primary concerns.

### **Proposed Solution**

The LRSC has developed the following strategy to address the neighborhood concerns:

- Install 7 offset chokers at various locations
- Install raised intersections at Linwood Drive and Essex Lane
- Install a mini roundabout at the Mills Lane Intersection
- Install new sidewalk to close an existing sidewalk gap on the west side from #103 to #129
- Replace existing severely damaged sidewalk.

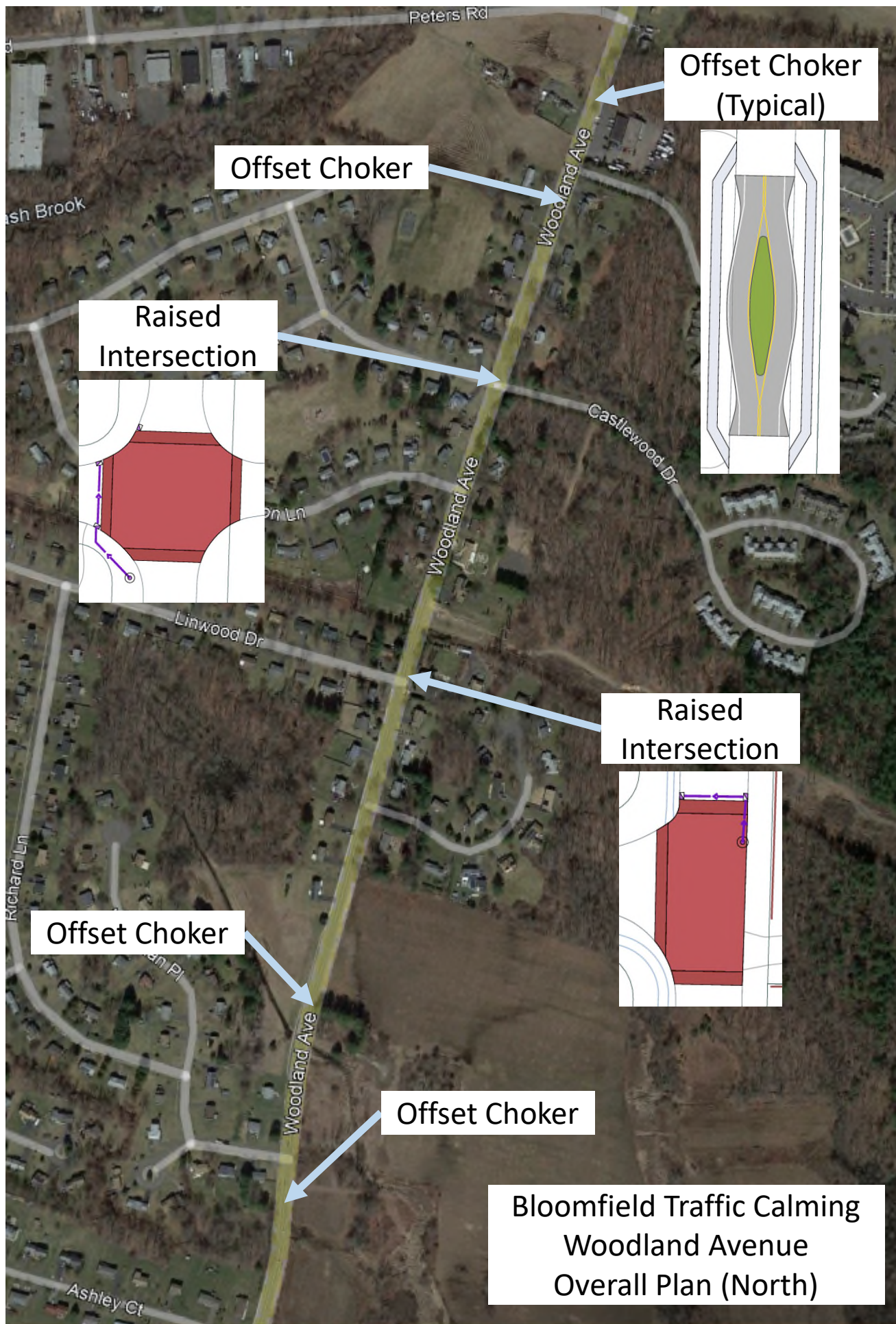



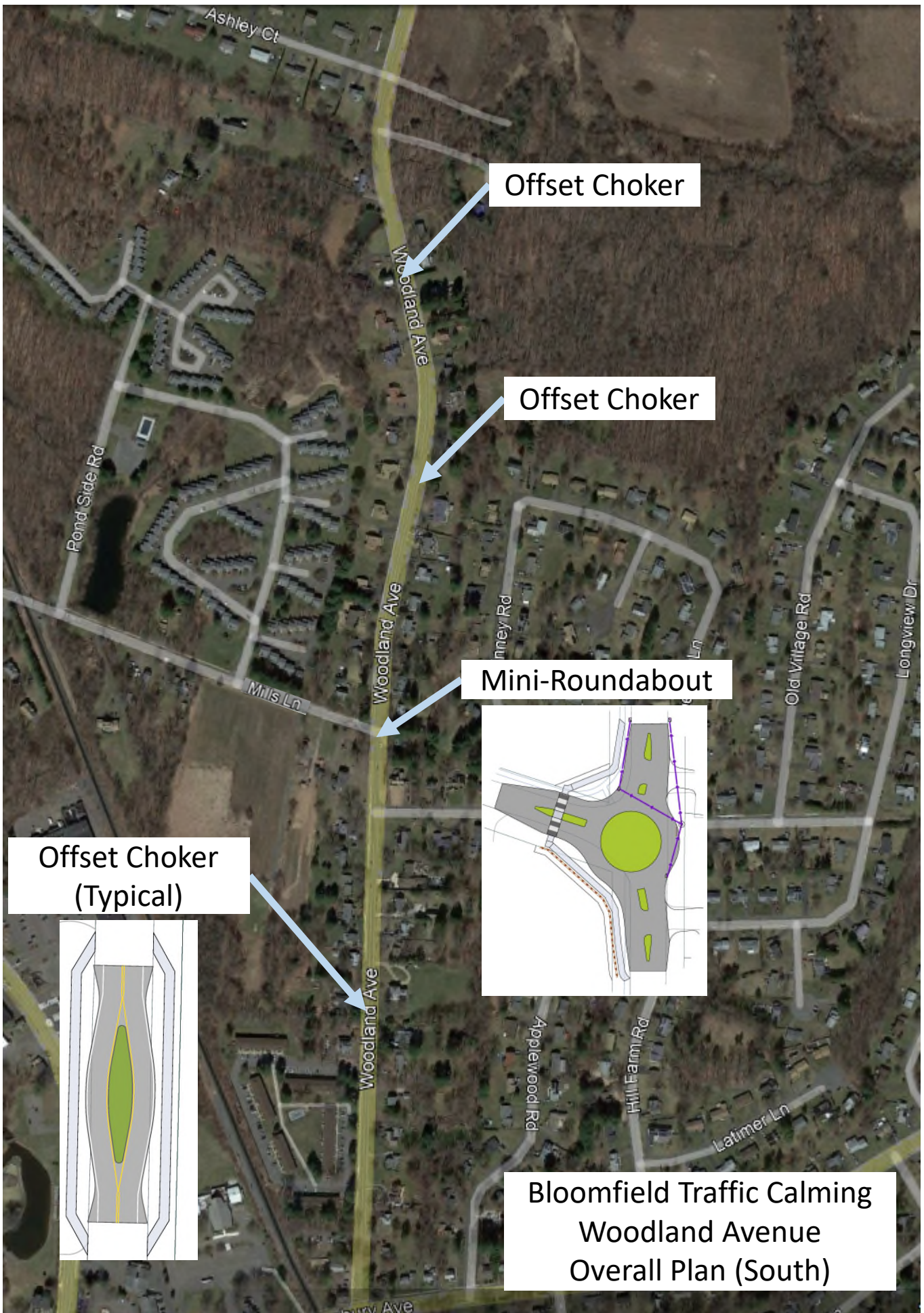

Offset Choker

Offset Choker

Mini-Roundabout

Offset Choker  
(Typical)

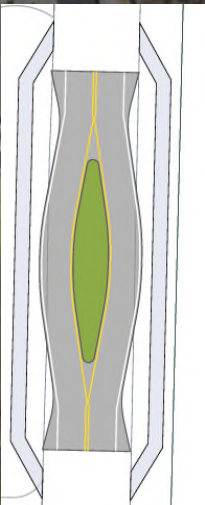

Bloomfield Traffic Calming  
Woodland Avenue  
Overall Plan (South)

**Bloomfield Traffic Calming  
Woodland Avenue  
1000' North of Wintonbury Avenue  
Offset Choker  
W-1**

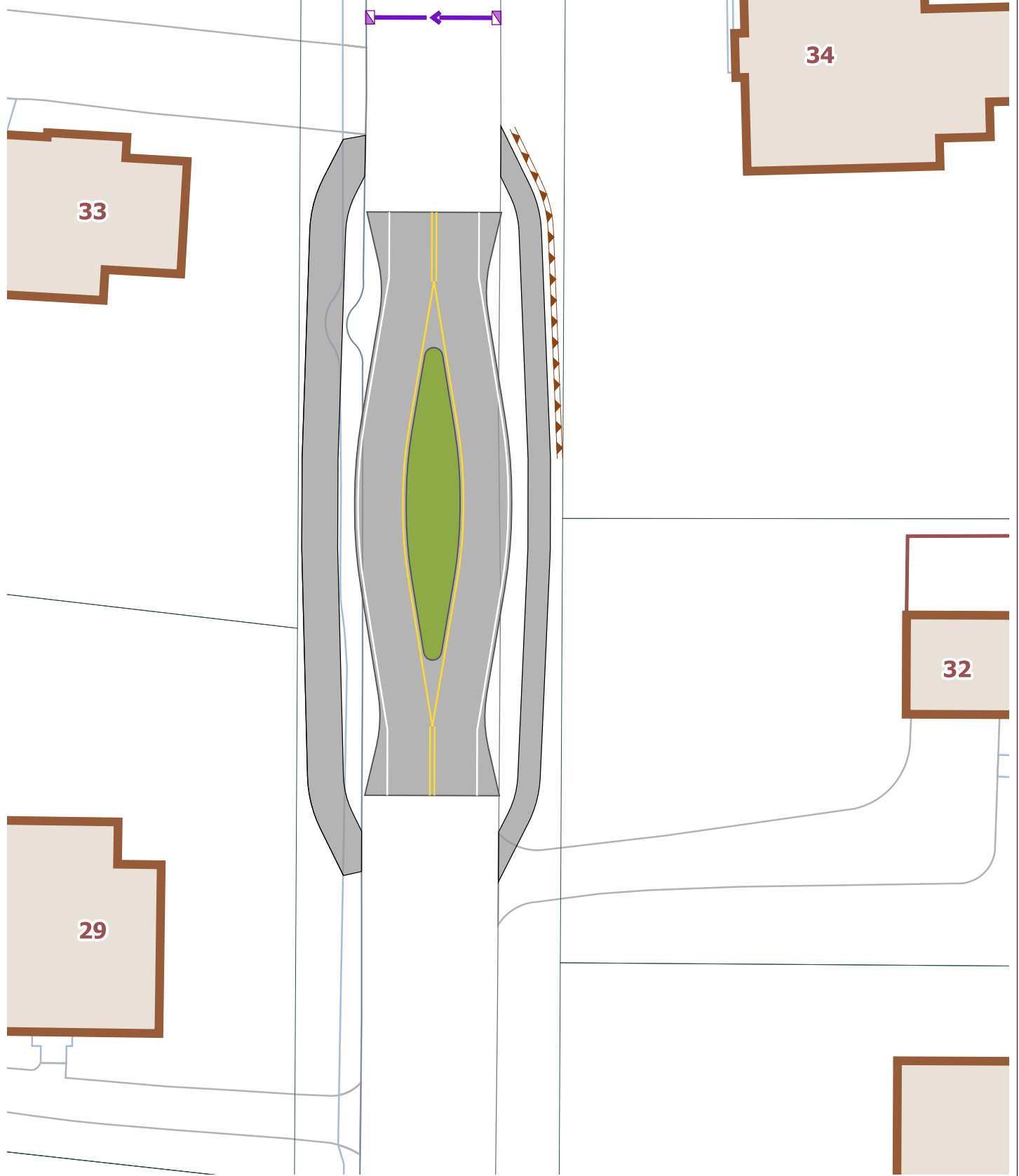

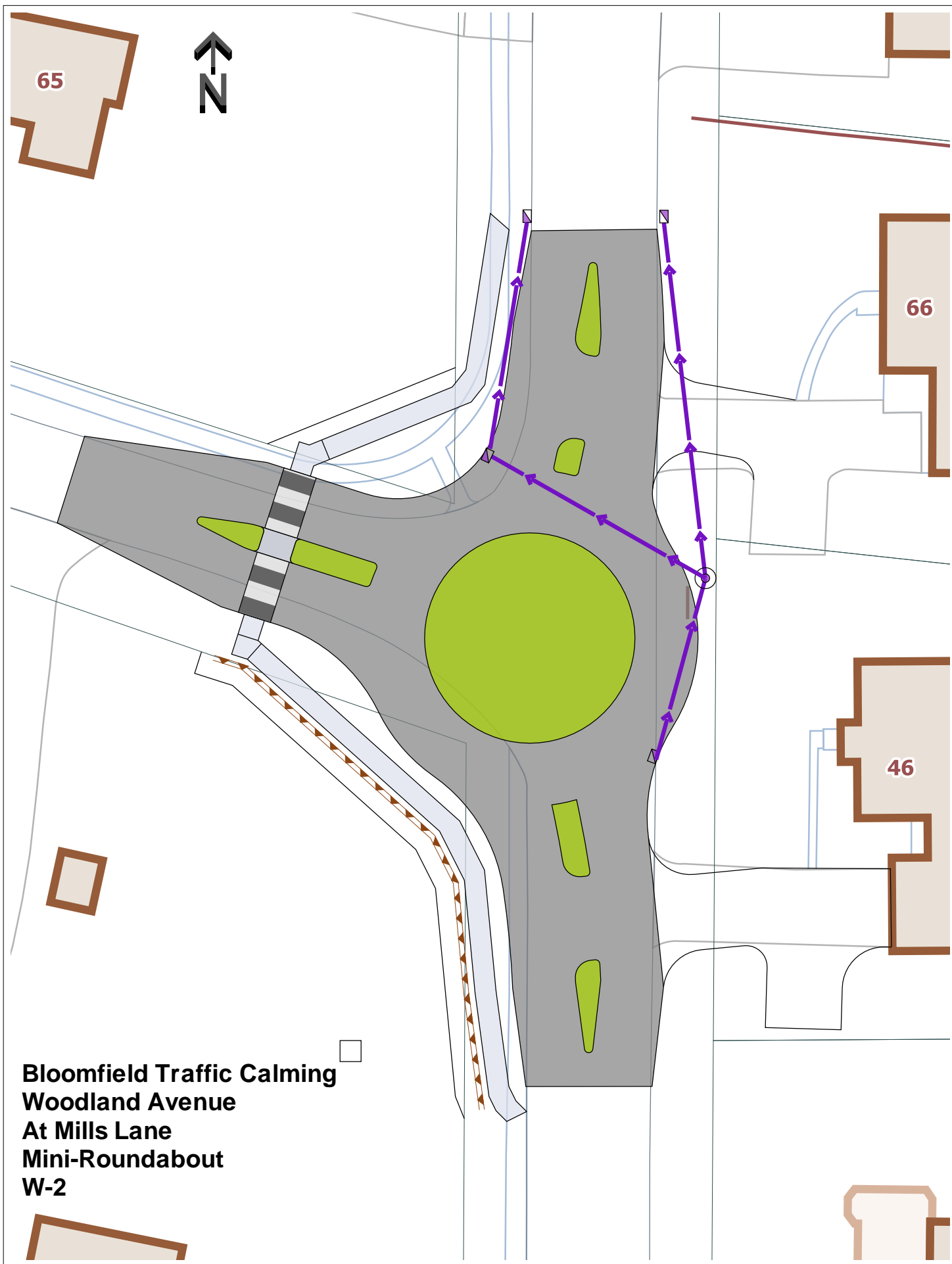

**Bloomfield Traffic Calming  
Woodland Avenue  
At Mills Lane  
Mini-Roundabout  
W-2**



**Bloomfield Traffic Calming  
Woodland Avenue  
800' North of Mills Lane  
Offset Choker  
W-3**



95

94

93

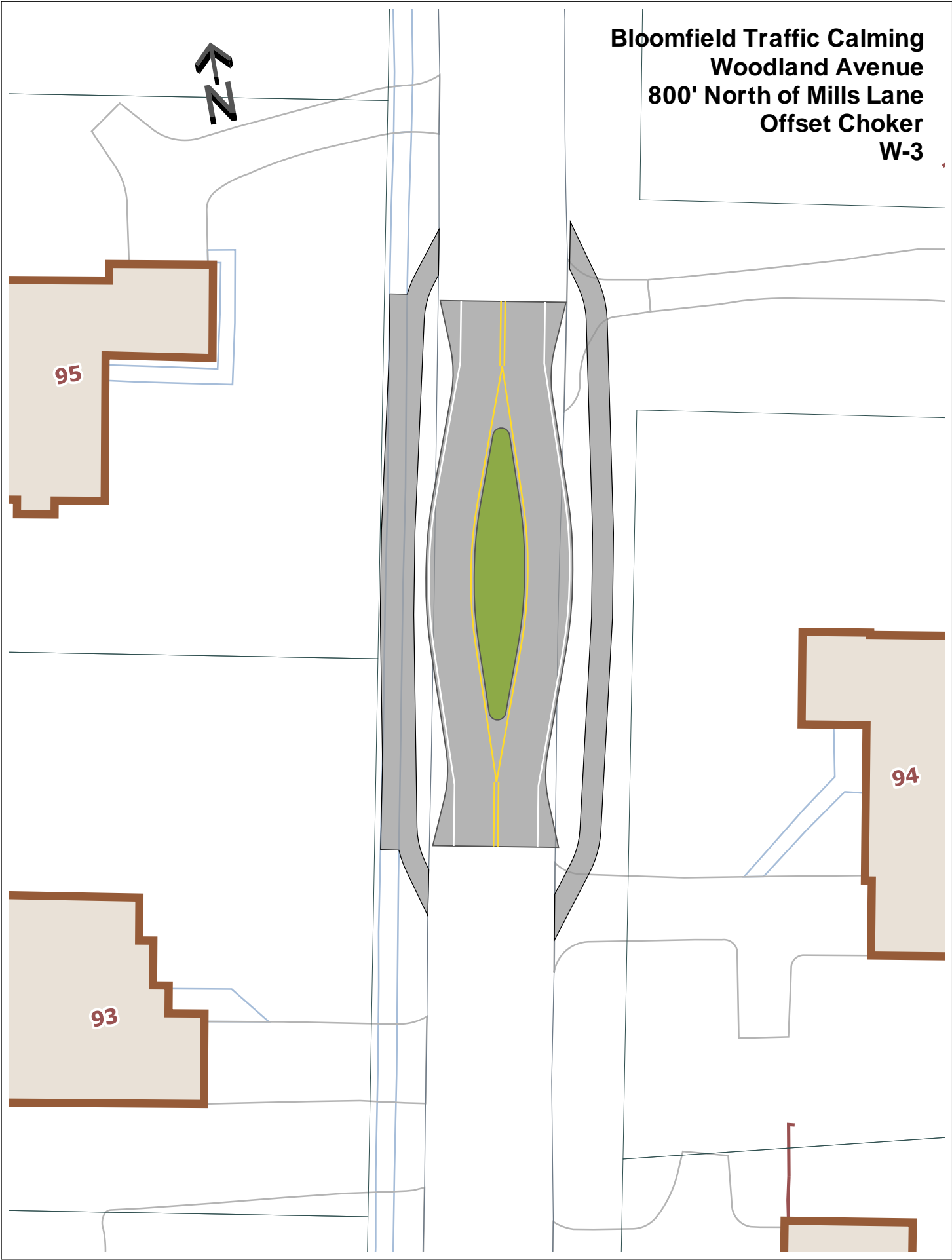

**Bloomfield Traffic Calming  
Woodland Avenue  
600' South of Ashley Court  
Offset Choker  
W-4**

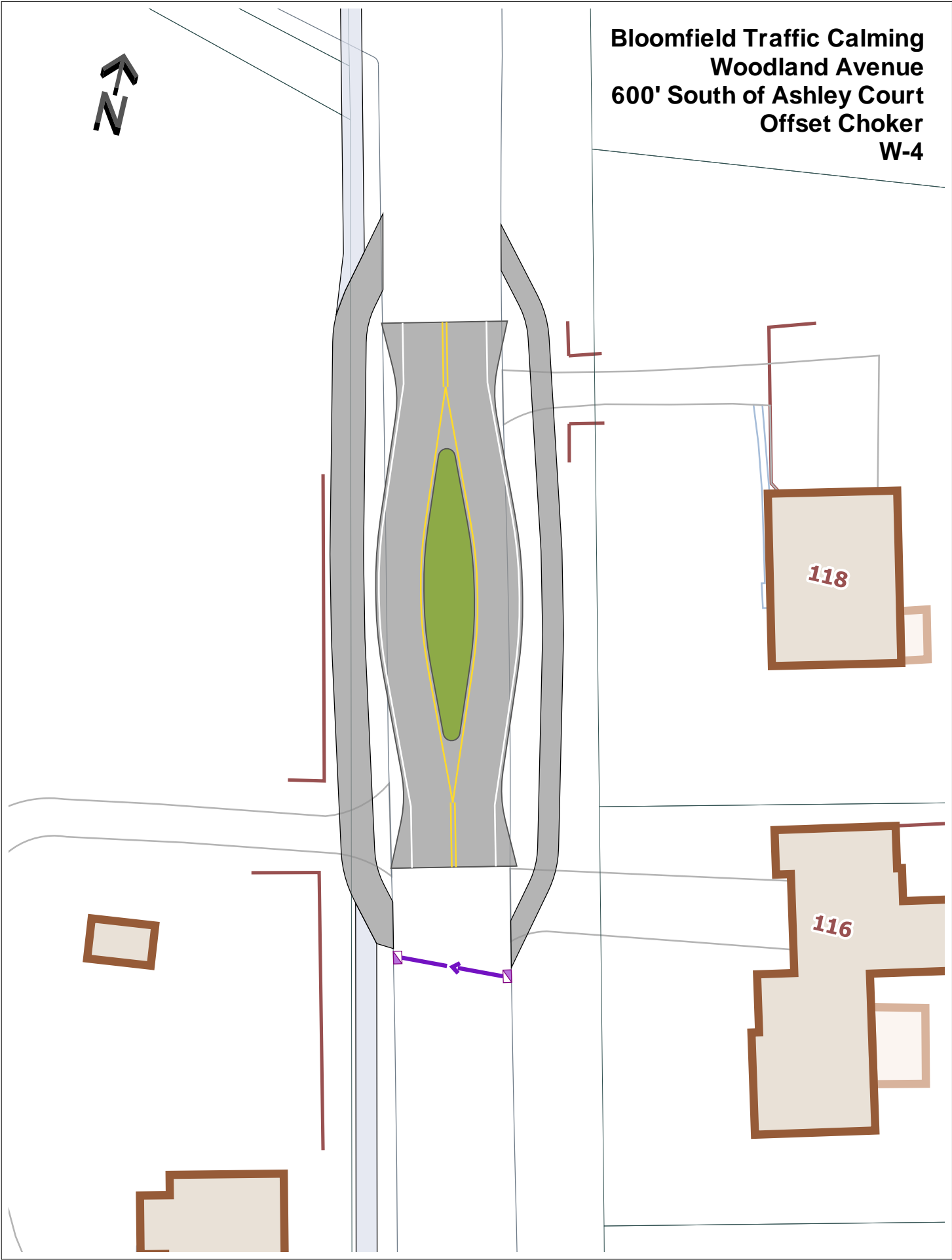

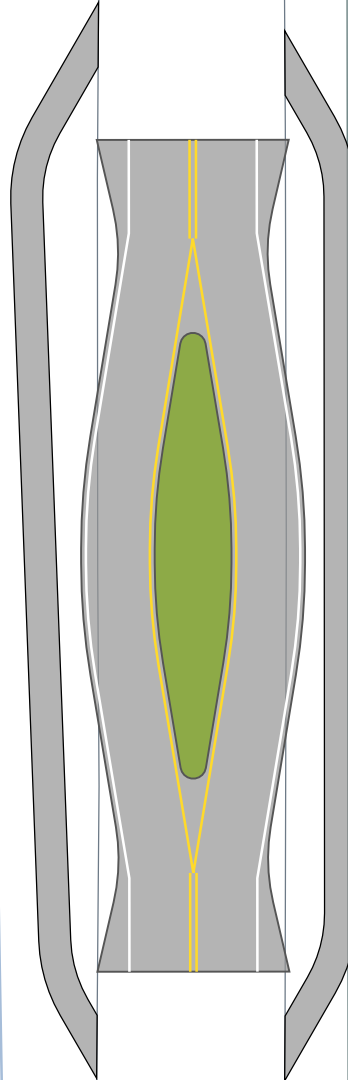
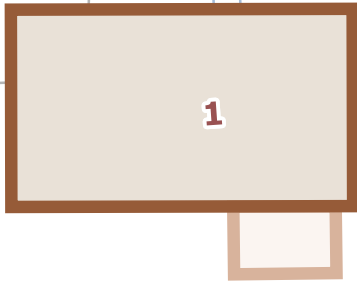

**Bloomfield Traffic Calming  
Woodland Avenue  
100' South of Evan Lane  
Offset Choker  
W-5**



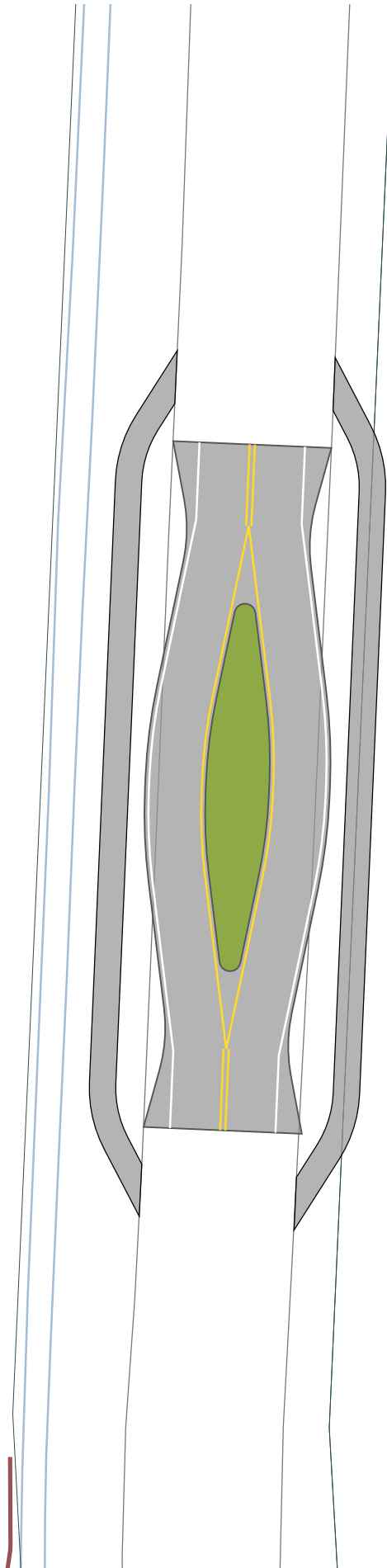

**Bloomfield Traffic Calming  
Woodland Avenue  
600' North of Evan Lane  
Offset Choker  
W-6**

**Bloomfield Traffic Calming  
Woodland Avenue  
At Linwood Drive  
Raised Intersection  
W-7**

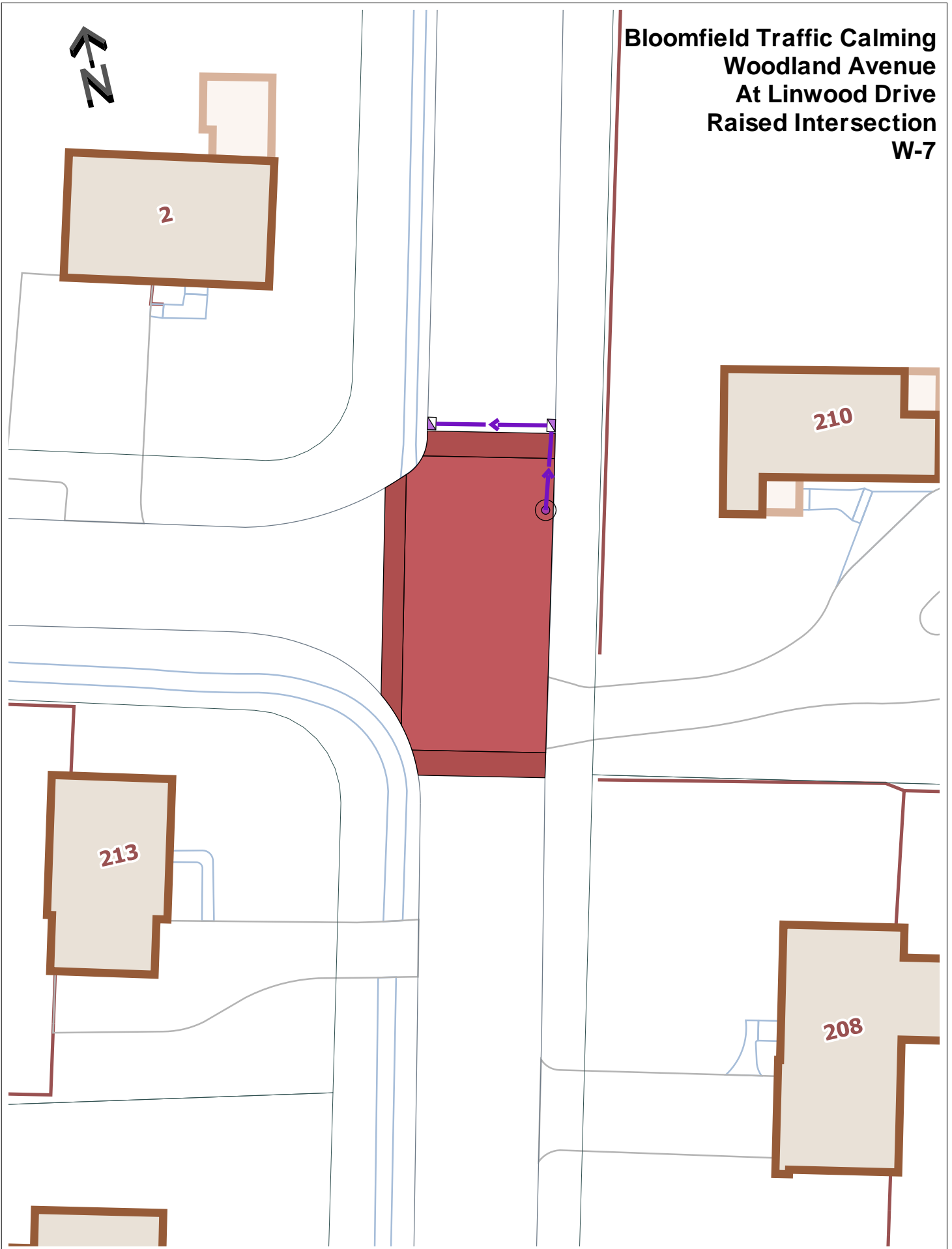

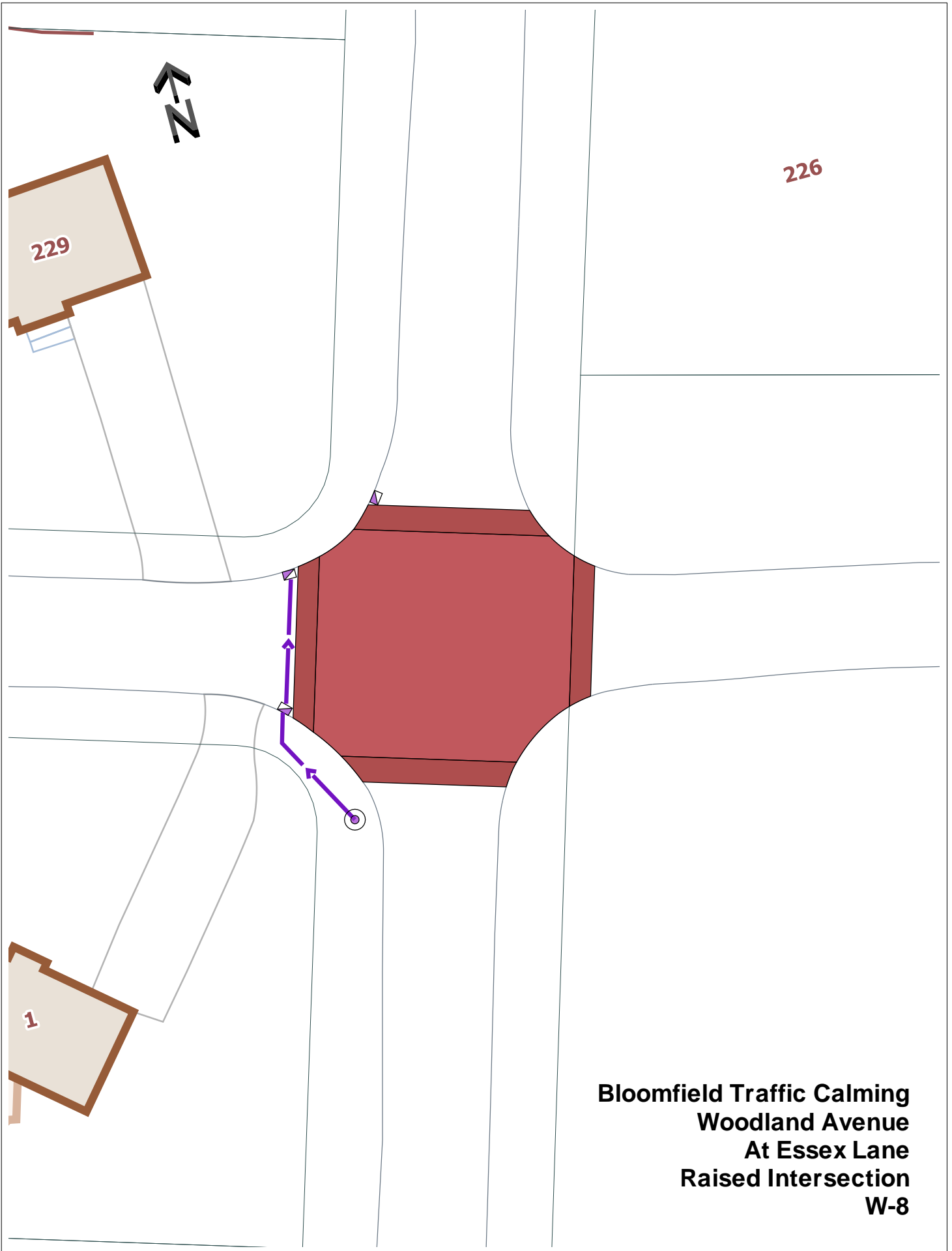

**Bloomfield Traffic Calming  
Woodland Avenue  
At Essex Lane  
Raised Intersection  
W-8**



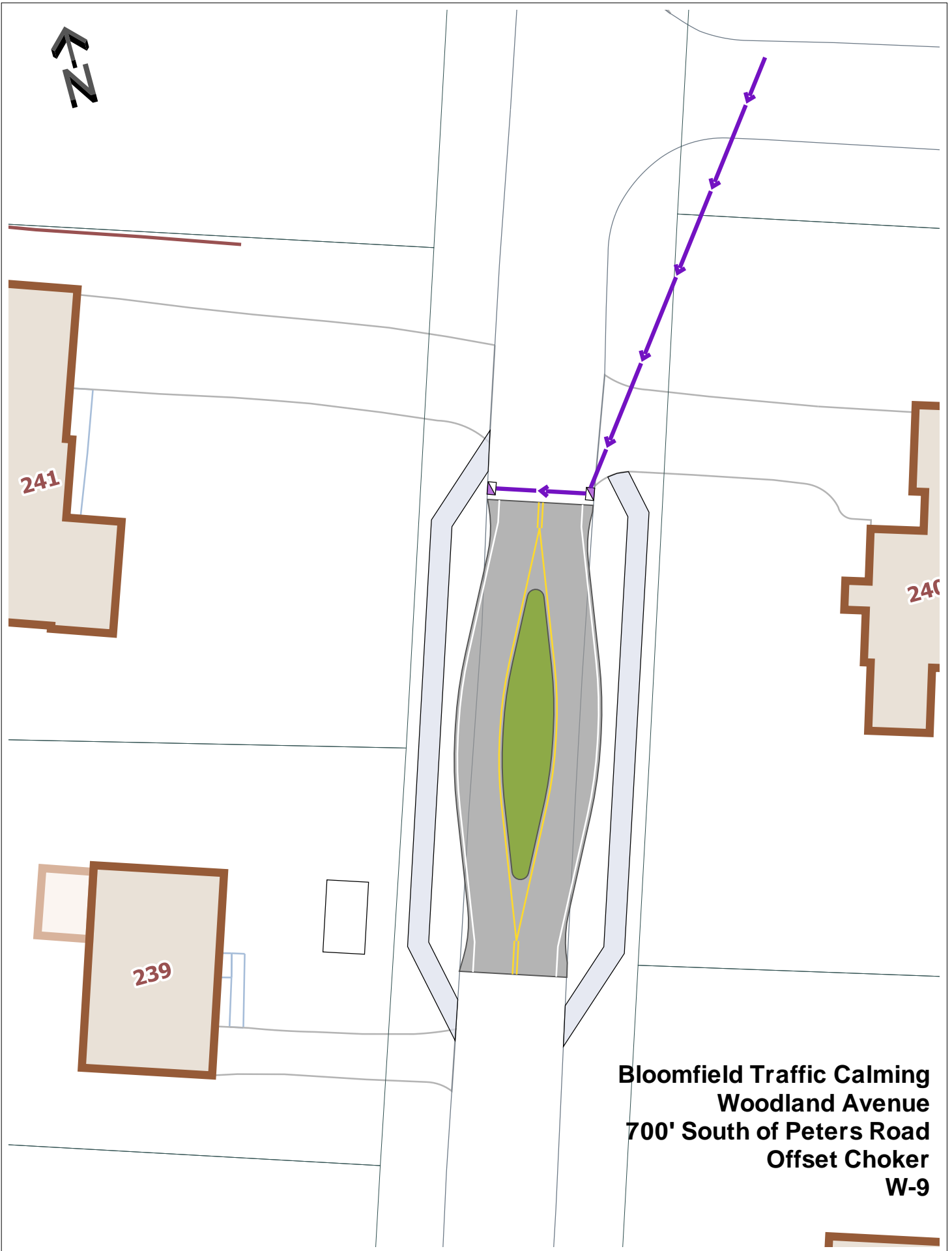

**Bloomfield Traffic Calming  
Woodland Avenue  
700' South of Peters Road  
Offset Choker  
W-9**

**Bloomfield Traffic Calming  
Woodland Avenue  
150' South of Peters Road  
Offset Choker  
W-10**

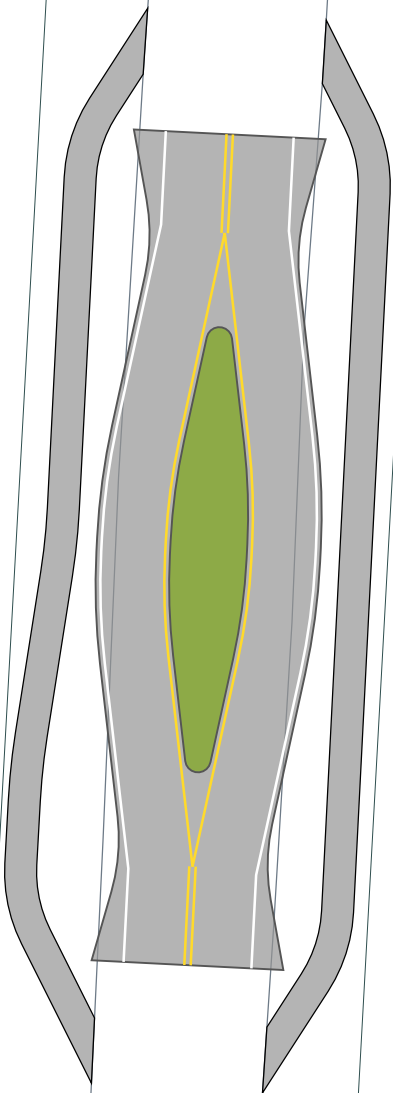

246